

OS SITE LOCATION PLAN
(Scale 1:1250)

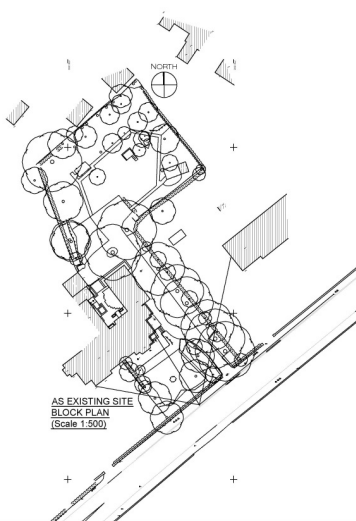

AS EXISTING SITE
BLOCK PLAN
(Scale 1:500)

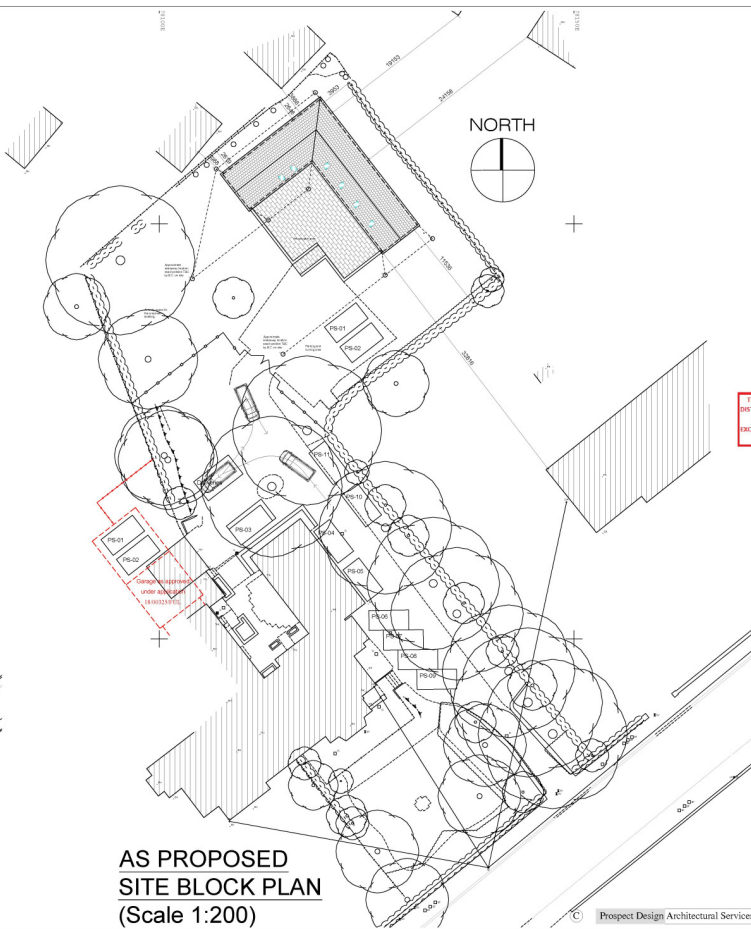

AS PROPOSED
SITE BLOCK PLAN
(Scale 1:200)

Notes
Do not scale from this drawing or consider any dimension to be accurate.
In the event of any discrepancy being found, these should be brought to the attention of the Prospector Design for further instruction.
This drawing is for Planning purposes only and is not to be considered a construction or setting out drawing.
North Point shown approximately.
The proposed layouts are subject to the following, although not exhaustive:
1. Structural Engineers Requirements
2. Mechanical and Electrical Engineers Requirements
3. Drainage Requirements
4. Planning approvals
5. Building Regulations approvals

THIS COPY HAS BEEN MADE BY OR WITH THE AUTHORITY OF HYDRAGE SYSTEMS LIMITED IN ACCORDANCE WITH SECTION 17 OF THE COPYRIGHT, DESIGN AND PATENTS ACT 1988. UNLESS THAT ACT PROVIDES A RELEVANT EXCEPTION TO COPYRIGHT, THIS COPY MUST NOT BE COPIED WITHOUT THE PRIOR PERMISSION OF THE COPYRIGHT OWNER.

Date valid 12/05/2019

F	Parking spaces / turning circle shown	J.W.	08.08.2019
K	Footlights around from the North elevation	J.W.	08.08.2019
B	Access generally related to site	J.W.	07.08.2019
C	Revised scheme following planning consultation	J.W.	08.08.2019
D	Revised scheme following planning consultation	J.W.	07.08.2019
A	Approved following design meeting	J.W.	06.08.2019
REV	AMENDMENT	DATE	

CONTRACTOR MUST VERIFY ALL DIMENSIONS ON SITE BEFORE COMMENCING ANY WORK OR MAKING ANY SHOP DRAWINGS

PROSPECT DESIGN
Architectural Services

24 Church House, Malton, N. Yorks, YO17 7HT
Tel: 01653 692272 Mob: 07792700035
Email: info@prospectdesign.co.uk web: www.prospectdesign.co.uk

Client: MR & MRS ABBOTT
DERWENT MOUNT
6 YORK ROAD
MALTON, YO17 7ND

Job Title:
PROPOSED NEW BUILD DWELLING ON
LAND TO THE REAR OF DERWENT
MOUNT, 6 YORK ROAD, MALTON

Drawing Title:
OS SITE LOCATION PLAN
AND SITE BLOCK PLANS

Scale: AS STATED @ A1 Drawn: R.W.
Date: 27.06.2017 Checked: --

Drawing Number:
PD227-04-F